



AirLink® LX40

Ultra Compact LTE or LTE-M/NB-IoT Commercial Router for Security Cameras, Digital Signage, IoT and Small Business



Benefits

- Out-of-the-box connectivity speeds time to operation
- Connect to a wide variety of devices from video to low-power IoT
- Compact size helps expand application deployment
- Leverage the world of IoT to drive new business opportunities

LX40 Product Description

The AirLink® LX40 is a compact LTE router offering “out-of-the box” LTE and Wi-Fi connectivity that is simple to install. The LX40 supports security, digital signage and IoT applications in fixed, protected environments.

LX40 LTE

Cat 4 LTE router capable of 150 Mbps downlink and 50 Mbps uplink speeds.

LX40 LTE-M/NB-IOT

LPWA (Low-Power Wide Area) variant for applications where low data rates, enhanced cellular coverage and global deployment is required.

Ideal Applications

IoT and enterprise applications including:

- Surveillance cameras
- Digital signage
- POS terminals
- Smart lockers
- Small business connectivity
- Distance learning

LX40 APPLICATION EXAMPLES

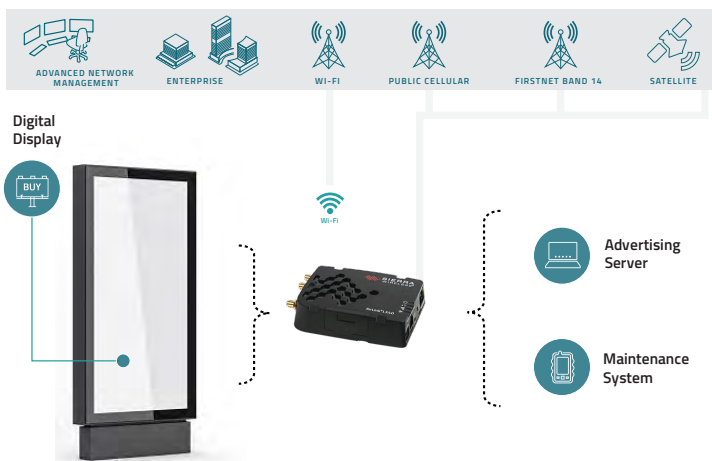

DIGITAL SIGNAGE



CONNECTED DISTANCE LEARNING



AIRLINK LX40 – ESSENTIAL SERIES ROUTER

Top Features	Device Variant	Specifications
LTE Supported	LX40 LTE	Cat4 LTE (150/50 Mbps) (DL/UL), HSPA+
	LX40 LTE-M/NB-IoT	Cat M1 (300/375 kbps), Cat-NB1 (27/65 kbps) (DL/UL)
Navigation	All	None
Wi-Fi	LX40 LTE (Optional)	Dual Band 2.4/5GHz Wi-Fi 802.11 Wave2, Client Mod Support for 10 clients, WPA2 Enterprise
Interfaces	All	Gigabit Ethernet port with POE (Power Over Ethernet) RS485 and RS-232 USB 2.0 Digital I/O and analog inputs
Security	All	Secure boot and secure firmware update, Remote Authentication, Inbound and Outbound Port filtering, Inbound and Outbound Trusted IP
Construction	All	Polycarbonate housings that meet MIL-810/IP20 environmental standards
Industry Certifications	All	Safety: IECCE Certification and SAE J1455 (Shock & Vibration) Vehicle Usage: E-Mark and SAE J1455 (Shock & Vibration)
Dimensions	All	103 mm x 79 mm x 25 mm 4.1 in x 3.1 in x 1.0 in
Warranty	All	3 years (with options for up to 5 years)
Regions and Carriers	LX40 LTE	North America - Verizon, AT&T/Generic, EMEA, Australia and New Zealand
	LX40 LTE-M/NB-IoT	Global

LX40 Services and Support

AirLink Complete: AirLink Complete is a subscription service that combines best-in-class device management software through AirLink Management Service (ALMS), industry-leading technical support and an extended warranty option. It delivers a cost-effective way to ensure your mission-critical infrastructure operates at peak efficiency. AirLink Complete is included free for 1 year with the purchase of a new LX40.

Device Management: AirLink Management Service (ALMS) is a secure cloud-based device management solution that supports over-the-air registration, configuration and software updates. ALMS Advanced Reporting and Analytics (ALMS ARA) adds advanced historical reporting and deeper insights to data.

Professional Services: Full product life-cycle services including solution consulting and solution implementation services delivered by Sierra Wireless Network Engineers and Program Managers.

About Sierra Wireless

Sierra Wireless (NASDAQ: SWIR) (TSX: SW) is the leading IoT solutions provider that combines devices, network and software to unlock value in the connected economy. Companies globally are adopting IoT to improve operational efficiency, create better customer experiences, improve their business models and create new revenue streams. Whether it's a solution to help a business securely connect edge devices to the cloud, or a software/API solution to help manage processes associated with billions of connected assets, or a platform to extract real-time data to make the best business decisions, Sierra Wireless will work with you to create the right industry-specific solution for your next IoT endeavor. Sierra Wireless has more than 1,300 employees globally and operates R&D centers in North America, Europe and Asia.



909 Ridgebrook Road., Sparks, Maryland 21152, USA
 TEL : +1-410-583-1701 FAX : +1-410-583-1704
 E-mail: sales@pulsesupply.com
<https://www.pulsesupply.com/sw-iwr>

